

**impol** FinAl

a member of **impol** 200 YEARS  
Aluminium Industry

Together, we build a sustainable  
future in the aluminium Industry.



# Location & Indicators

Strategic locations: Slovenia, Serbia, Croatia

					
<b>6<sup>th</sup></b>	<b>5X</b>	<b>2.500</b>	<b>210.400</b>	<b>879,9 mio</b>	<b>400 mio</b>
largest Slovenian exporter	increase in sales volume over the past 30 years	employees	tons of products produced in a year	annual turnover	investment in last 10 years



**PRODUCTION SITES**

- 1 Impol, Slovenia
- 2 Impol Seval, Serbia
- 3 Impol-TLM, Croatia

**OFFICE**

- 4 Impol Aluminum Corp., NY

**Impol Group,**  
Slovenia - Headquarters (Area - 221.520 m2)

**Impol Seval,**  
Serbia (Area - 147.398 m2)

**Impol-TLM,**  
Croatia (Area - 467.325 m2)



# Vertical integration

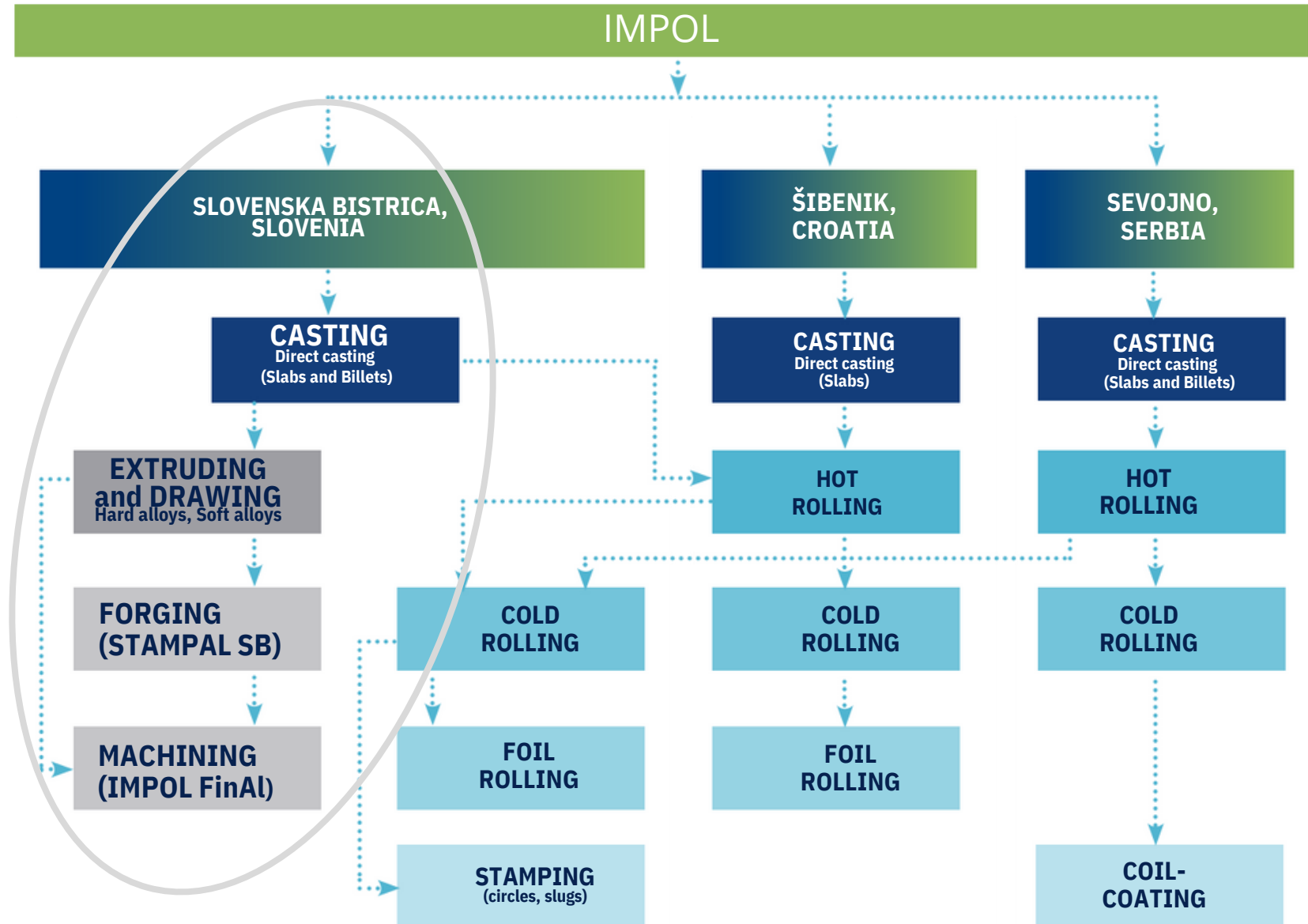

# Extrusion

## SOFT ALLOYS PLANT

12.5 MN 20 MN 28 MN 40 MN

Diameter of input billet [mm]	152	203	228	279.4 - 282
Optimal sections [mm <sup>2</sup> ]	180 - 550	400 - 1500	700 - 3700	2000 - 11300
Optimal length of section [mm]	800 - 7530	1500 - 12400	1500 - 8400	1500 - 8000

## HARD ALLOYS PLANT

20 MN 35 MN 55 MN

Diameter of input billet [mm]	218	275	279.4 - 282
Optimal sections of products [mm <sup>2</sup> ]	35 - 3340	300 - 12670	314 - 25000
Optimal length of products [mm]	2000 - 6000	2000 - 6000	2000 - 6000



# Dimensional limitations

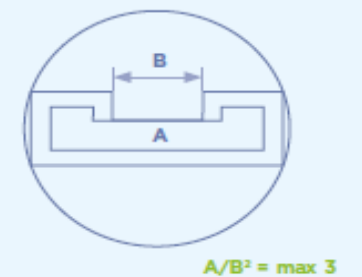
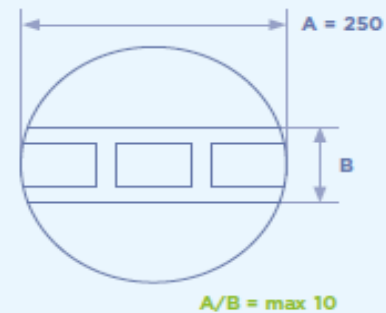
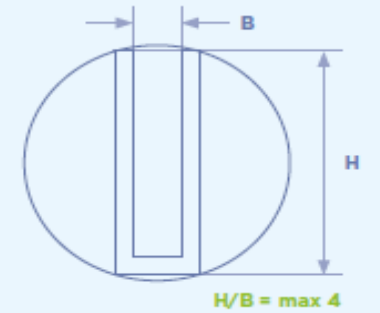
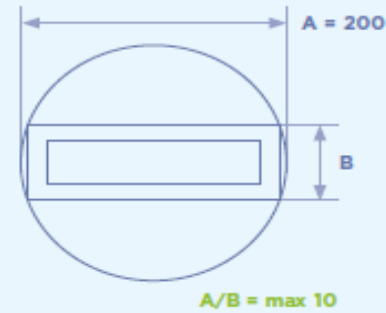
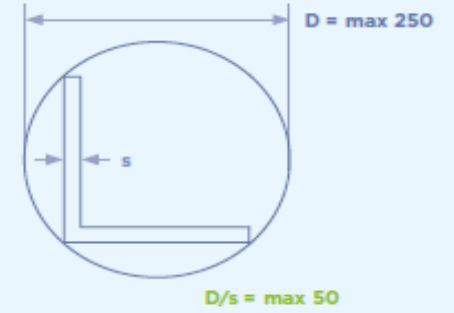
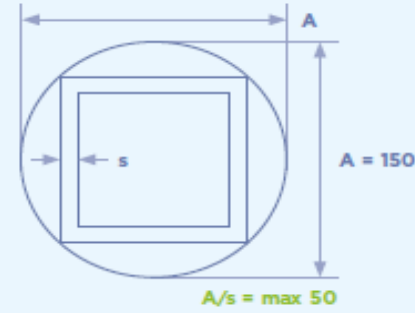
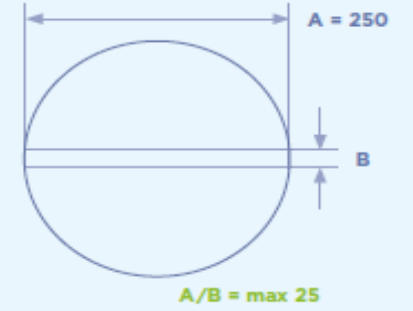
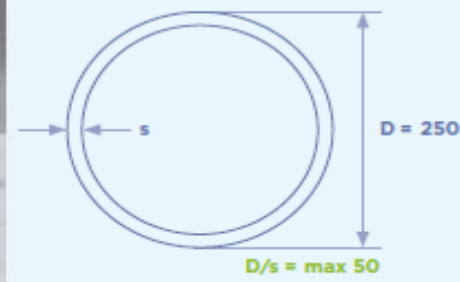

# Tubes

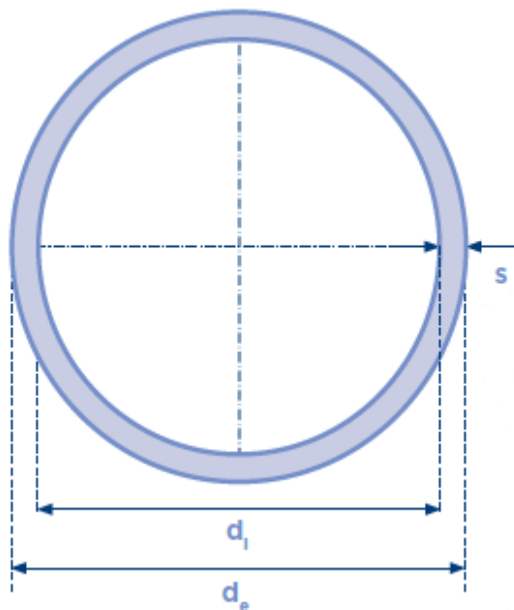

## SEAMLESS TUBES

	$d_e$ [mm]	$d_i$ [mm]	$s$ [mm]	length [m]
Extruded	755/7	25.0 - 90.0	16.0 - 74.0	2.5 - 25.0
				2.0 - 4.5 or based on customer's requirements
Drawn	754/7	25.0 - 76.2	16.0 - 74.0	2.5 - 25.0
				1.0 - 4.5 or based on customer's requirements (min. 1.5 kg/m and max. 9 kg/m)

## CHAMBER EXTRUDED TUBES

	$d_e$ [mm]	$s$ [mm]
Extruded	755/8	10.0 - 250.0
		1.5 - 25.0 Square tubes are available from 10x10 to 220x220.

## FERRULES - OVAL TUBES

In accordance with DIN 3093 standard, from no. 16 to 32.

# Forging (STAMPAL)

WIDE RANGE OF FORGED PRODUCTS

(FROM 50G UP TO 7.5 KG)

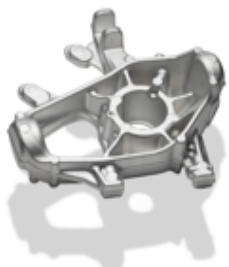

## ANALYSES

Matematical

- Micro and macro analyses
- Grain size
- Chemical structure
- Hardness

Dimensional control

- 3D scanner (ATOS/GOM)
- Calipers custom made
- Digital equipment measurement

ANNUALLY FORGED AROUND 3.5 MIO. BLANKS



Post-processing operations on forged parts

HIGH QUALITY PARTS WITH IMPORTANT VISUAL ASPECT



CHOICE OF DIFFERENT ALLOYS  
2xxx, 6xxx, 7xxx

# Forging (STAMPAL)

## 8 FORGING PRESSES

FROM 0.45 MN TO 2.4 MN

4 SPINDLE PRESSES,  
3 DIRECT DRIVE PRESSES,  
1 MECHANICAL (ECCENTRIC) PRESS

---

## 7 TRIMMING PRESSES

---

HEAT TREATMENT  
EQUIPMENT (T4/T6)

### EQUIPMENT FOR:

- ✓ TUMBLING
- ✓ PICKLING
- ✓ LIQUID PENETRANT CONTROL
- ✓ INOX BLASTING
- ✓ ALUBLASTING
- ✓ 3D SCANNING TECHNOLOGY
- ✓ REVERSE ENGINEERING
- ✓ FORGING SIMULATION...

# Machining (IMPOL FinAI)

Technologies

Cold forming



Milling / Drilling



Turning



Punching / inserting nuts



Assembly



Surface treatment:  
Washing,  
Anodizing (ext.),  
Passivation.



Bending & stretch bending

# Machining (IMPOL FinAl)

## Mechanical equipment

**High-speed CNC machining - we process profiles and forgings with extremely tight tolerances:**

**Lathes** - machining range diameter 5 mm - 220 mm, machining length 950 mm,

**Vertical 3-axis machines**, machining up to 1950 mm (850 mm x 750 mm x 1950 mm),

**Vertical 4-axis machines**, machining up to 950 mm (650 mm x 650 mm x 950 mm),

**Vertical 5-axis machining center**, up to 720 mm (500 mm x 500 mm x 720 mm).



**Additional:**  
equipment / lines  
internally to round  
up the service to  
our customers



Fully automated  
specific lines

Custom made machine  
for tube forming

Deburring  
stations

Washing  
lines

Externally  
(anodization...)

Fully automated  
robot manipulation

Automated  
sawing lines

Cold forming  
tooling

Passivation  
lines

# Production segments

The future of mobility



**MOTOCYCLES**



**AUTOMOTIVE**

# Motorcycles

Unveiling the power within



# Automotive

Driven by innovation

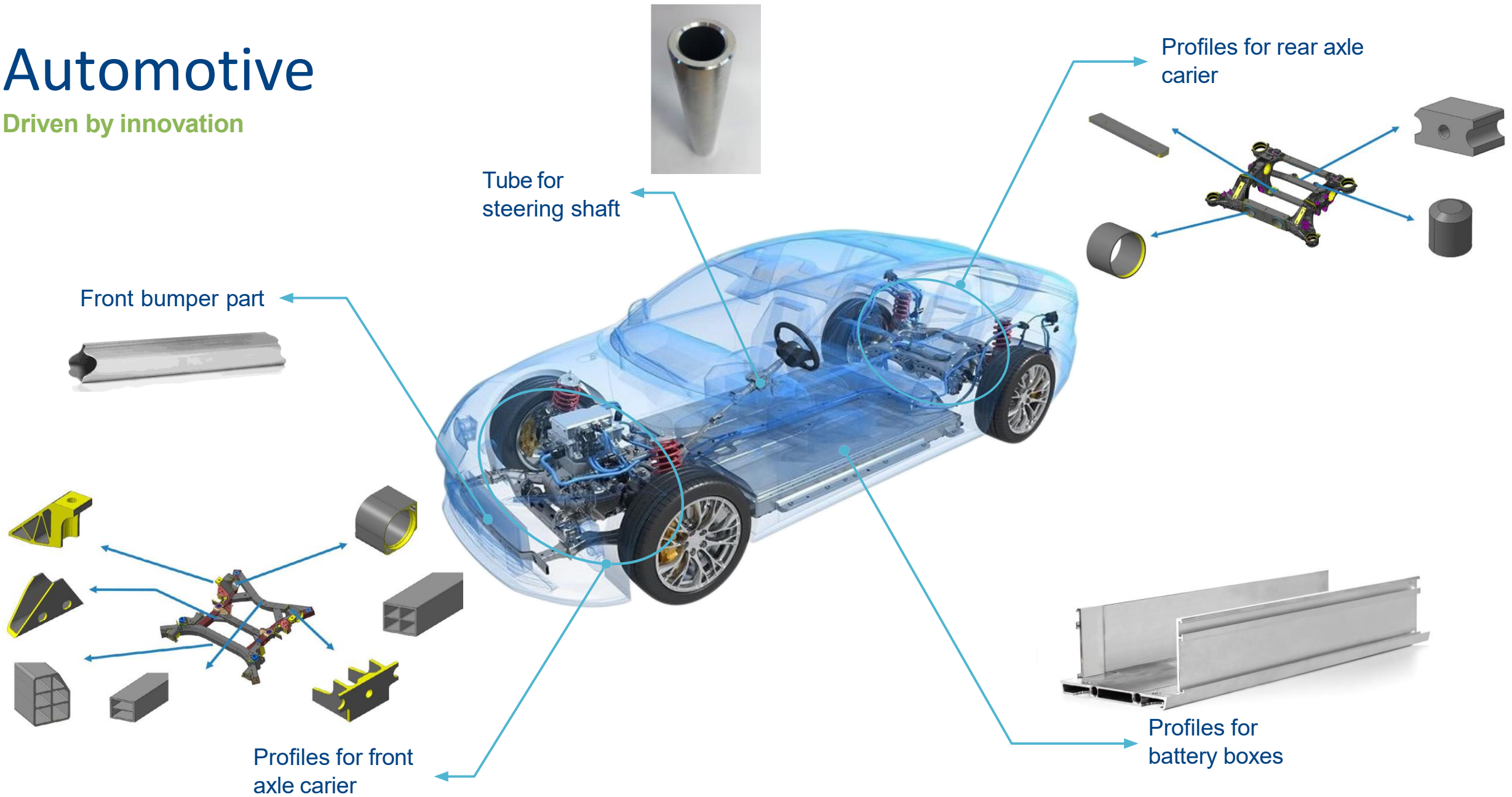

# Circular Economy, Sustainable Future

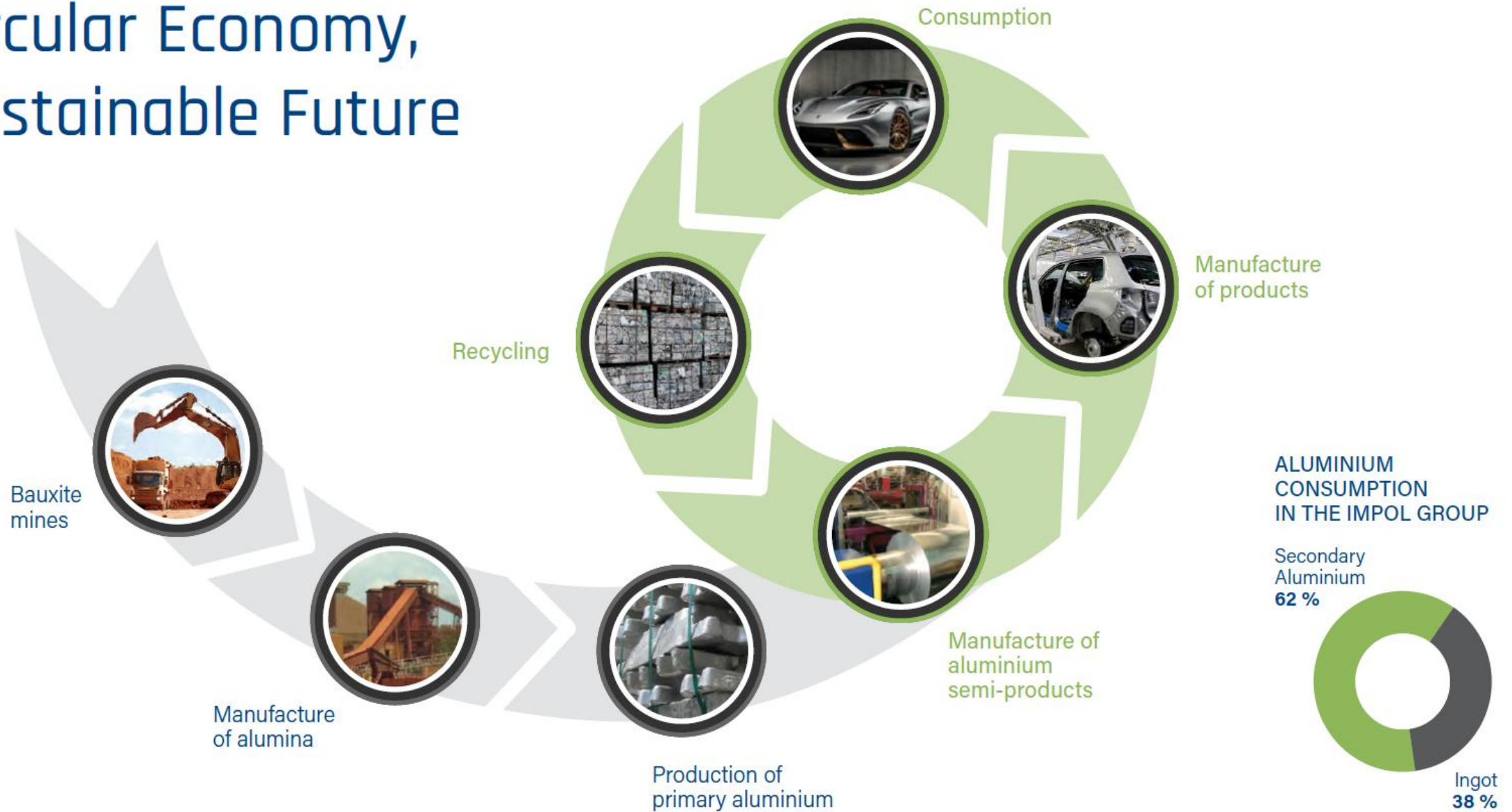

# Impol's Brand InfiniAL

Our contribution to global sustainability commitments

- Low carbon footprint,
- high recycled aluminum content in accordance with ISO 14021,
- high proportion of secondary raw materials,
- superior quality.

**impol**  
Aluminium Industry

Infini**AL**



The new InfiniAL brand of extruded and rolled products was developed in accordance with the sustainable development strategy of the Impol Group.

**InfiniAL LC**

products with low carbon footprint

**InfiniAL RC**

products with higher recycled content

**InfiniAL SC**

products with higher secondary content

# Reducing Carbon Footprint is our Commitment

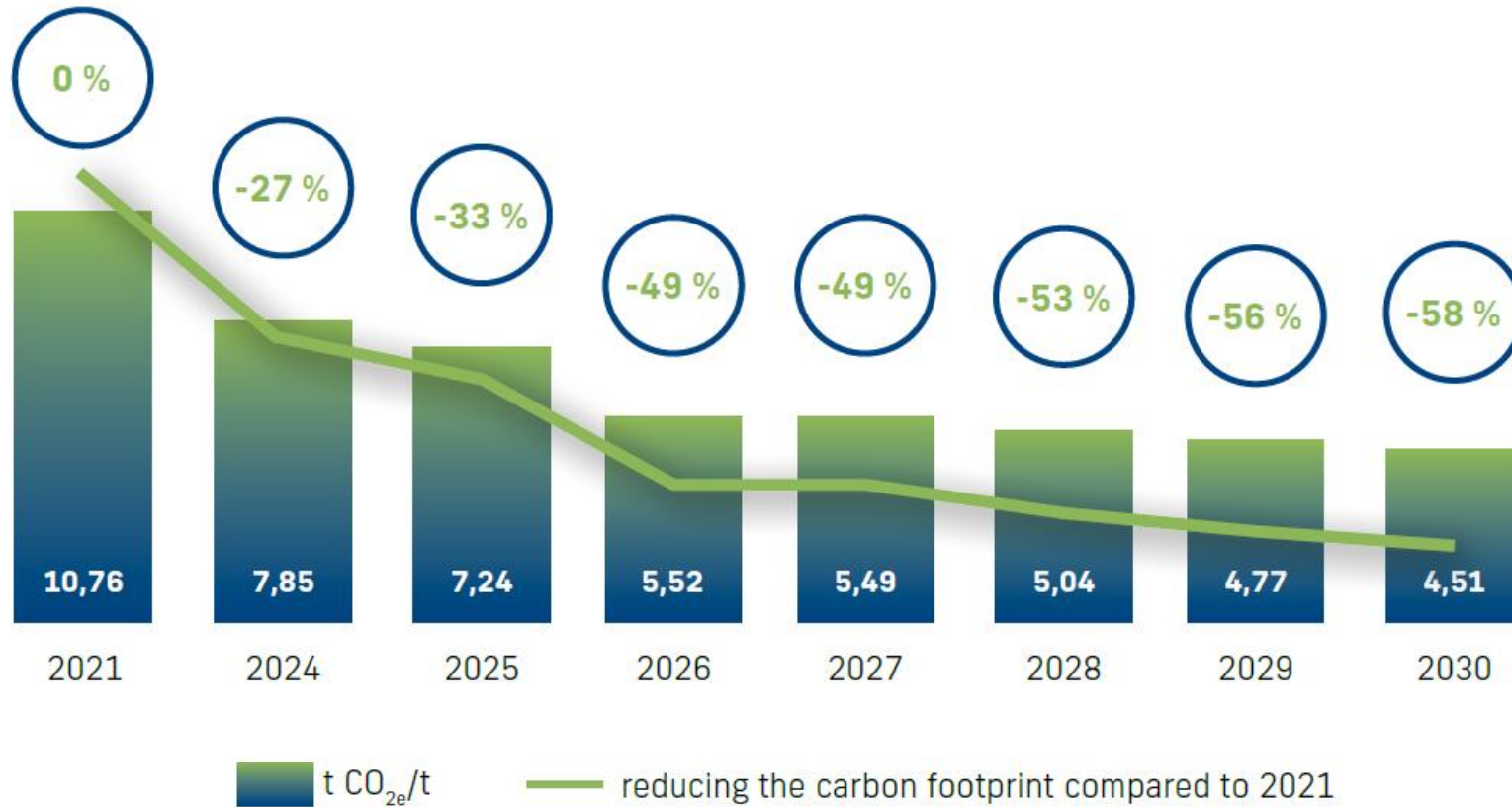

# Impol Group

## Customer benefits

### ALLOYS PRODUCED

#### Aluminium Alloys

- 6XXX series
- 7XXX series

### MATERIAL SPECS

#### OEM approved material specifications

- **Mercedes Benz:** DBL 1172.10, DBL 1172.20, DBL 1172.30, DBL 1172.40, DBL 1172.50,
- **BMW:** GS 93047 (CHA-T1, CHA, STD-T1, STD, CRA-T1, CRA, HST-T1, HST)
- **VW Group:** TL 116 N20/C20, TL 116 N24/C24, TL 116-C/N-28 (in approval)

**Impol:**  
our operations  
are based on  
standards of  
excellence



ISO 9001  
since 1992

ISO 14001  
since 2000

ISO 45001  
since 2000

IATF 16949  
since 2004

EN 9100  
since 2019

ISO 50001  
since 2023

EN 15088  
since 2012

SA 8000  
since 2023

ASI Performance  
since 2020

# Impol Group

## Customer benefits

### TRADITIONAL

#### 200 years of tradition

- Founded in 1825 / from Cu to Al / SI independence / investments in region / expansion into finalization in 2018

### SUSTAINABLE

#### Sustainability

- Impol's InfiniAl brand can support objective to lower carbon footprint in product portfolio,

### CONSOLIDATED

#### One-stop shop (from billet to finished part)

- From casting through extrusion, forging to machining within one industrial zone in Slovenia,

### OPTIMIZED

#### Supply chain optimization

- Optimize supply chain risk with IMPOL's triple site production (Slovenia, Croatia, Serbia),

### STABLE

#### Financial stability

- Stability is achieved through diversification into different industrial segments

# Impol Group

Direct customers

OEM



TIER 1



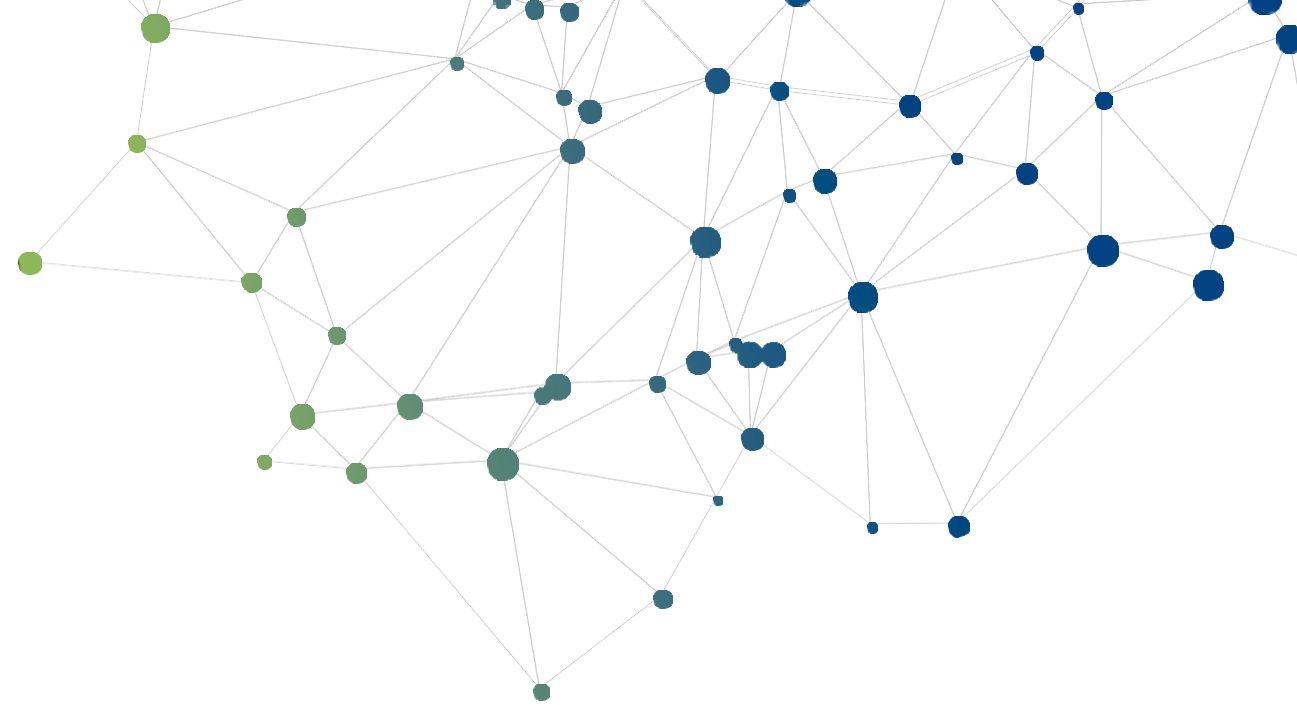

Impol –  
Past, Present,  
Future.

